

5-STAR 1500 ULTRA ER ROLL UP SHUTTER CATALOG

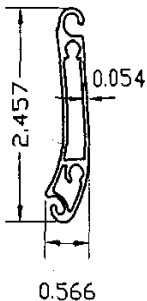

		LIST PRICE
RE1AC5ER	1500 PRINCIPAL SLAT NON VENTED END RETENTION-WHITE	3.74
RE1AC57ER	1500 PRINCIPAL SLAT NON VENTED END RETENTION 7 METER-WHITE	3.74
RE8AC5ER	1500 PRINCIPAL SLAT NON VENTED END RETENTION-IVORY	3.74
RE8AC57ER	1500 PRINCIPAL SLAT NON VENTED END RETENTION 7 METER - IVORY	3.74
REAA5ER	1500 PRINCIPAL SLAT NON VENTED END RETENTION-AM BRONZE	3.74
REAA57ER	1500 PRINCIPAL SLAT NON VENTED END RETENTION 7 METER- AM BRONZE	3.74
RECA5ER	1500 PRINCIPAL SLAT NON VENTED END RETENTION-LT BEIGE	3.74
RECA57ER	1500 PRINCIPAL SLAT NON VENTED END RETENTION 7 METER - LT BEIGE	3.74

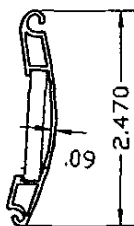

RE1AP6	EXTRUDED RE-1500 PUNCHED SLAT-WHITE	3.83
RE1AP67	EXTRUDED RE-1500 PUNCHED SLAT*7 METER LONG-WHITE	3.83
RE8AP6	EXTRUDED RE-1500 PUNCHED SLAT-IVORY	3.83
RE8AP67	EXTRUDED RE-1500 PUNCHED SLAT*7 METER LONG-IVORY	3.83
REAA6	EXTRUDED RE-1500 PUNCHED SLAT-AM BRONZE	4.32
REAA67	EXTRUDED RE-1500 PUNCHED SLAT*7 METER LONG-AM BRONZE	4.32
RECA6	EXTRUDED RE-1500 PUNCHED SLAT-LT BEIGE	3.87
RECA67	EXTRUDED RE-1500 PUNCHED SLAT*7 METER LONG-LT BEIGE	3.87



MET-PM5	LEXAN 1500 VIEW PORT INSERT	2.67
---------	-----------------------------	------



RE1IP5	INTERMEDIATE PERFORATED SLAT RE-1500-WHITE	1.27
RE1IP57	INTERMEDIATE PERFORATED SLAT RE-1500*7 METER LONG-WHITE	1.36
RE8IP5	INTERMEDIATE PERFORATED SLAT RE-1500-IVORY	1.36
RE8IP57	INTERMEDIATE PERFORATED SLAT RE-1500*7 METER LONG-IVORY	1.36
REAI5	INTERMEDIATE PERFORATED SLAT RE-1500-AM BRONZE	1.67
REAI57	INTERMEDIATE PERFORATED SLAT RE-1500*7 METER-AM BRONZE	1.67
RECI5	INTERMEDIATE PERFORATED SLAT RE-1500-LT BEIGE	1.36
RECI57	INTERMEDIATE PERFORATED SLAT RE-1500*7 METER-LT BEIGE	1.36
RE1IC5	INTERMEDIATE BLIND SLAT RE-1500-WHITE	1.18
RE8IC5	INTERMEDIATE BLIND SLAT RE-1500-IVORY	1.18
REAI5	INTERMEDIATE BLIND SLAT RE-1500-AM BRONZE	1.42
RECI5	INTERMEDIATE BLIND SLAT RE-1500-LT BEIGE	1.36

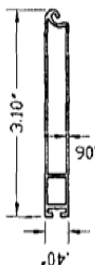

BAS1AT5	5-STAR EXT ALUM BASESLAT 1500 SERIES-WHITE	4.45
BAS1AT57	5-STAR EXT ALUM BASESLAT 1500 SERIES 7 METER-WHITE	4.45
BAS8AT5	5-STAR EXT ALUM BASESLAT 1500 SERIES-IVORY	4.45
BAS8AT57	5-STAR EXT ALUM BASESLAT 1500 SERIES 7 METER-IVORY	4.45
BASAAT5	5-STAR EXT ALUM BASESLAT 1500 SERIES-AM BRONZE	4.82
BASAAT57	5-STAR EXT ALUM BASESLAT 1500 SERIES 7 METER-AM BRONZE	4.82
BASCAT5	5-STAR EXT ALUM BASESLAT 1500 SERIES-LT BEIGE	4.57
BASCAT57	5-STAR EXT ALUM BASESLAT 1500 SERIES 7 METER-LT BEIGE	4.82

WEANGTC	MINI BASESLAT WEATHER SEAL	0.15
---------	----------------------------	------

5-STAR 1500 ULTRA ER ROLL UP SHUTTER CATALOG

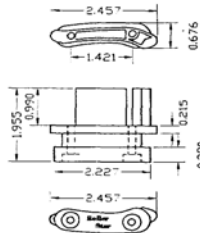

LOC-1AT5ER	SLAT LOCK 1500 SERIES END RETENTION PR	1.74
LOC-1AT6	SLAT LOCK 1500 SERIES PUNCHED PR	1.06

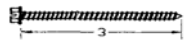

D- SLAT RETENTION SCREW
#14X3" HEX HEAD SDS

TOR-1500U	1500 ULTRA SLAT LOCK FASTENER	0.675
-----------	-------------------------------	-------



SLH-AC5	SPRING LOCK HANGER 1500 SERIES	8.41
---------	--------------------------------	------

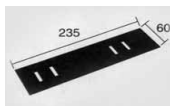

PRO-GO1	RUBBER SLAT PROTECTOR 1500 SERIES	12.17
---------	-----------------------------------	-------

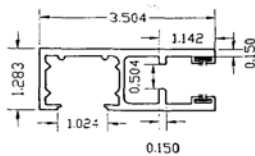

GUI1OCER	3.5" OPEN CHANNEL GUIDE RAIL END RETENTION-WHITE	14.40
GUI8OCER	3.5" OPEN CHANNEL END RETENTION GUIDE RAIL-IVORY	14.40
GUIAOCER	3.5" OPEN CHANNEL END RETENTION GUIDE RAIL-AM BRONZE	14.40
GUICOCER	3.5" OPEN CHANNEL END RETENTION GUIDE RAIL-LT BEIGE	14.40

WEA-7HF4	4MM BRUSH INSERT	0.15
----------	------------------	------

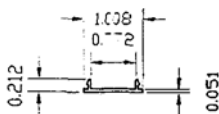

GUI1OCCER	OPEN CHANNEL GUIDE COVER END RETENTION-WHITE	0.93
GUI8OCCER	OPEN CHANNEL GUIDE COVER END RETENTION-IVORY	0.93
GUIAOCCER	OPEN CHANNEL GUIDE COVER END RETENTION-AM BRONZE	0.93
GUICOCCER	OPEN CHANNEL GUIDE COVER END RETENTION-LT BEIGE	0.93



5-STAR 1500 ULTRA ER ROLL UP SHUTTER CATALOG